

For more information, please visit:



www.oraimo.com @oraimo\_accessories

**WELCOME GUIDE**

Necklace Lite | OEB-311 |

\* For safety issue, the product remains low capacity during shipping. Please fully charge the product before the initial use!

**PACKAGE CONTENTS**

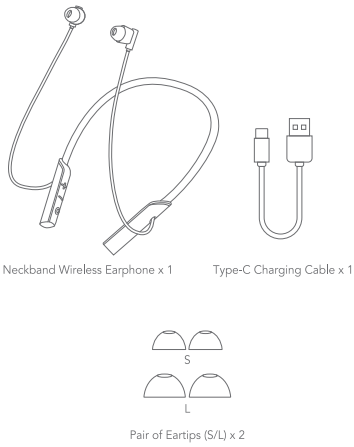

\*The original earphone comes with medium-sized ear tips attached.

**PRODUCT OVERVIEW**

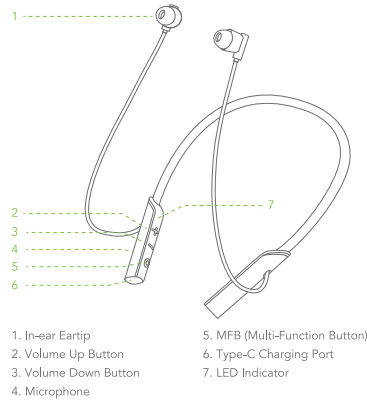

**BASIC PRODUCT SPECIFICATIONS**

BT Version	V5.3
Wireless Range	10m
Playtime	Up to 30 hours
Battery Capacity	220mAh
Charging Input	5V=1A

**USING YOUR EARPHONE**

- 1. Turn on / off**  
❖ Power on/ Power off: Long press "O" button till Necklace Lite vibrates once.  
❖ The earphone will automatically turn off after 3 minutes if no device is connected.

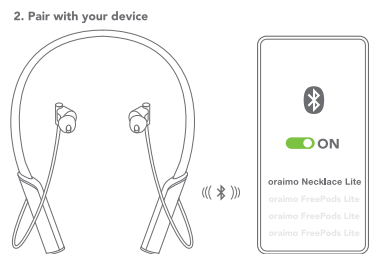

LED Indicator	Status
Fast flashing green	Pairing
Steady green for 2 seconds then lights off	Connected

- Fast flashing green Steady green Lights off
- ❖ Earphone will enter pairing mode automatically once turned on. Long press the MFB and Volume Up button at the same time for 2 seconds to connect the second device.
- ❖ Make sure the distance of the earphone and your device is less than 1 metre or 3 feet at the first time of connection.
- ❖ When turned on, the earphone will automatically connect to the last connected device if available. If not, the earphone will enter pairing mode.

**3. Charge your earphone**

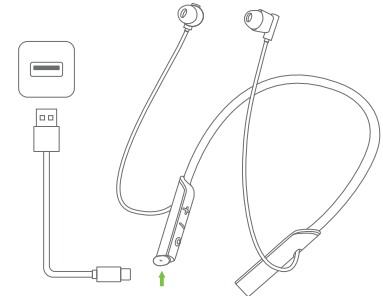

LED Indicator	Status
Green blinks quickly	Battery Percentage < 90%
Green blinks slowly	90% < Battery Percentage < 100%
Green on 2 mins, then off	Fully charged

❖ Use the included Type-C charging cable to charge the earphone and make sure it is fully charged before first use.

**CONTROLS**

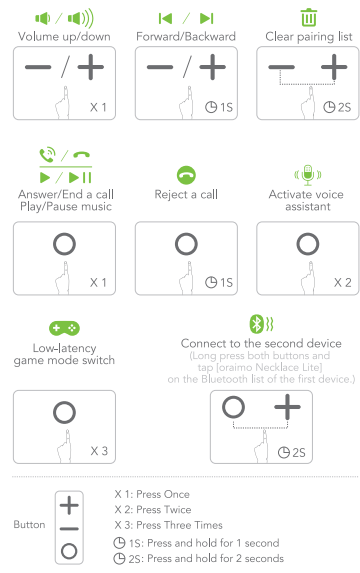

Button  
 X 1: Press Once  
 X 2: Press Twice  
 X 3: Press Three Times  
 15s: Press and hold for 1 second  
 25s: Press and hold for 2 seconds

**ATTENTION**

- To preserve battery lifespan, fully charge at least once a month.
- Use original or certified cables.
- Do not expose to liquids.
- Do not disassemble.
- Avoid dropping.
- Avoid extreme temperatures.
- Do not use the product outdoors during a thunderstorm.
- Do not use any corrosive cleaner/oil to clean.

**TROUBLE SHOOTING**

Problem Description	Cause	Solution
Power on function fails.	The battery is exhausted.	Use the charger to fully charge the battery.
Charging function fails.	The charging port is not properly connected.	Reconnect the charging port.
Power off function fails.	The earphone program is in error due to an incorrect operation.	Use the charger to charge and reset the earphone.
The earphone cannot be searched or pairing fails.	The earphone does not enter into the pairing mode.	Enable the earphone to enter into the pairing mode.
	The Bluetooth function of the device is in error.	Restart the device and then pair with the earphone.

**CONSIDERATE HINTS**

- Do not turn up the volume to a fair high level constantly as this could shorten the service life of this product or impair your hearing.
- When encounter any fault during operation, please cut off the power supply and disconnect the USB cable to prevent further damage to the product or other components.
- The wireless transmission range or connectivity could be by affected low battery power. In that case, please recharge immediately.